

Lakshmi Pulleys can be used on 'V' and wedge belts. Pulleys are manufactured as per IS 3142-1965 groove specifications and special grade cast iron. customized sizes and special bush type pulleys are available

Lakshmi Easy Fit dual duty Pulleys

FOR USE WITH SPZ BELTS

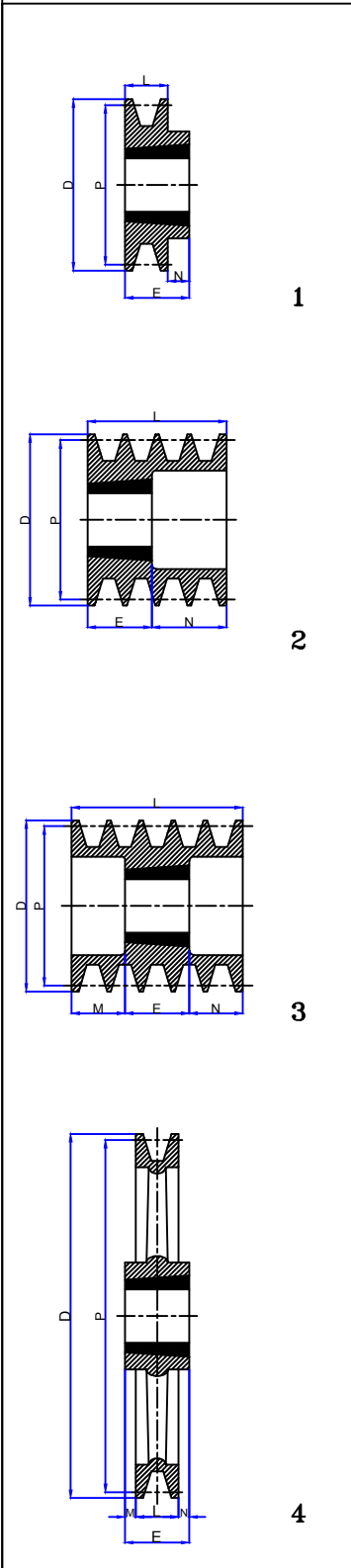

Pitch Dia	No.Of Grooves	Bush No.	Max Bore	Pulley Type	L mm	M mm	E mm	N mm	Outside Dia'D'
67	1	1108	28	1	16	-	23.5	7.5	72.5
	2	1108	28	6	28	4.5	23.5	0	
	3	1108	28	6	40	16.5	23.5	0	
71	1	1108	28	1	16	-	23.5	7.5	76.5
	2	1108	28	6	28	-	28	0	
	3	1108	28	6	40	13.5	26.5	0	
75	1	1108	28	1	16	-	23.5	7.5	80.5
	2	1210	32	6	28	-	28	0	
	3	1210	32	6	40	13.5	26.5	0	
80	1	1210	32	1	16	-	26.5	10.5	85.5
	2	1210	32	6	28	0	28	0	
	3	1210	32	6	40	13.5	26.5	0	
	4	1210	32	6	52	25.5	26.5	0	
85	1	1210	32	1	16	-	26.5	10.5	90.5
	2	1610	42	6	28	0	28	0	
	3	1610	42	6	40	13.5	26.5	0	
	4	1610	42	6	52	25.5	26.5	0	
	5	1610	42	6	64	37.5	26.5	0	
90	1	1210	32	1	16	-	26.5	10.5	95.5
	2	1610	42	6	28	0	28	0	
	3	1610	42	6	40	13.5	26.5	0	
	4	1610	42	6	52	25.5	26.5	0	
	5	1610	42	6	64	37.5	26.5	0	
	6	1610	42	6	76	49.5	26.5	0	
95	1	1210	32	1	16	-	26.5	10.5	100.5
	2	1610	42	6	28	0	28	0	
	3	1610	42	6	40	13.5	26.5	0	
	4	1610	42	6	52	25.5	26.5	0	
	5	1610	42	6	64	37.5	26.5	0	
	6	1610	42	6	76	49.5	26.5	0	
100	1	1210	32	1	16	-	26.5	10.5	105.5
	2	1610	42	6	28	0	28	0	
	3	1610	42	6	40	13.5	26.5	0	
	4	2012	50	6	52	18.5	33.5	0	
	5	2012	50	6	64	30.5	33.5	0	
	6	2012	50	6	76	42.5	33.5	0	
112	1	1610	42	1	16	-	26.5	10.5	117.5
	2	1610	42	6	28	0	28	0	
	3	2012	50	6	40	13.5	26.5	0	
	4	2012	50	6	52	18.5	33.5	0	
	5	2012	50	6	64	30.5	33.5	0	
	6	2012	50	6	76	42.5	33.5	0	
125	1	1610	42	1	16	-	26.5	10.5	130.5
	2	1610	42	6	28	0	28	0	
	3	2012	50	6	40	6.5	33.5	0	
	4	2012	50	6	52	18.5	33.5	0	
	5	2517	60	6	64	17.5	46.5	0	
	6	2517	60	6	76	29.5	46.5	0	

FOR MAXIMUM BORES REFER LAKSHMI EASYFIT BUSH CATALOGUE

Lakshmi Easy Fit dual duty Pulleys

FOR USE WITH SPZ BELTS

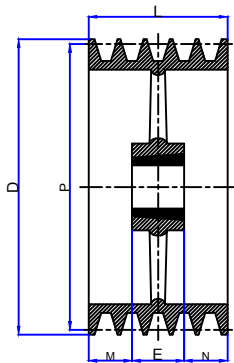

5

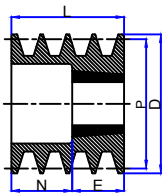

6

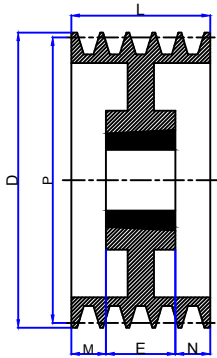

7

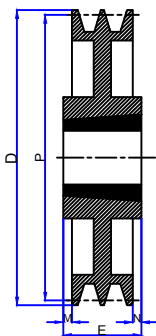

8

Pitch Dia	No.Of Grooves	Bush No.	Max Bore	Pulley Type	L mm	M mm	E mm	N mm	Outside Dia 'D'
140	1	1610	42	1	16	—	26.5	10.5	145.6
	2	1610	42	3	28	0	28	0	
	3	2012	50	2	40	—	33.5	6.5	
	4	2012	50	2	52	—	33.5	18.5	
	5	2517	60	2	64	—	46.5	17.5	
	6	2517	60	2	76	—	46.5	29.5	
160	1	1610	42	1	16	—	26.5	10.5	165.5
	2	2012	50	1	28	—	33.5	5.5	
	3	2012	50	2	40	—	33.5	6.5	
	4	2517	60	2	52	—	46.5	5.5	
	5	2517	60	2	64	—	46.5	17.5	
	6	2517	60	2	76	—	46.5	29.5	
180	1	1610	42	1	16	—	26.5	10.5	185.5
	2	2012	50	1	28	—	33.5	5.5	
	3	2012	50	2	40	—	33.5	6.5	
	4	2517	60	2	52	—	46.5	5.5	
	5	2517	60	2	64	—	46.5	17.5	
	6	2517	60	2	76	—	46.5	29.5	
200	1	2012	50	1	16	—	33.5	17.5	205.5
	2	2012	50	1	28	—	33.5	5.5	
	3	2012	50	2	40	—	33.5	6.5	
	4	2517	60	7	52	3.5	45	3.5	
	5	2517	60	7	64	9.5	45	9.5	
	6	2517	60	7	76	15.5	45	15.5	
250	1	2012	50	4	16	8	32	8	255.5
	2	2012	50	4	28	2	32	2	
	3	2012	50	5	40	4	32	2.5	
	4	2517	60	5	52	3.5	45	3.5	
	5	2517	60	5	64	9.5	45	9.5	
	6	2517	60	5	76	15.5	45	15.5	
315	1	2012	50	4	16	8	32	8	320.5
	2	2012	50	4	28	2	32	2	
	3	2517	60	4	40	2.5	45	2.5	
	4	2517	60	5	52	3.5	45	3.5	
	5	2517	60	5	64	9.5	45	9.5	
	6	2517	60	5	76	15.5	45	15.5	
400	1	2012	50	4	16	8	32	8	405.5
	2	2517	60	4	28	8.5	45	8.5	
	3	2517	60	4	40	2.5	45	2.5	
	4	2517	60	5	52	3.5	45	3.5	
	5	3020	75	5	64	6.5	51	6.5	
	6	3020	75	4	76	0	76	0	
500	2	2517	60	4	28	8.5	45	8.5	505.5
	3	2517	60	4	40	2.5	45	2.5	
	4	3020	75	5	52	0.5	51	0.5	
	5	3030	75	4	64	6	76	6	
	6	3030	75	4	76	0	76	0	
	6	3535	90	4	76	6.5	89	6.5	
630	3	2517	60	4	40	2.5	45	2.5	635.5
	4	3030	75	4	52	12	76	12	
	5	3030	75	4	64	6	76	6	
	6	3535	90	4	76	6.5	89	6.5	
800	3	3020	75	4	40	5.5	51	5.5	805.5
	4	3030	75	4	52	12	76	12	
	5	3535	90	4	64	12.5	89	12.5	
	6	3545	90	4	76	6.5	89	6.5	

FOR MAXIMUM BORES REFER LAKSHMI EASYFIT BUSH CATALOGUE